

SEE BELOW LEFT

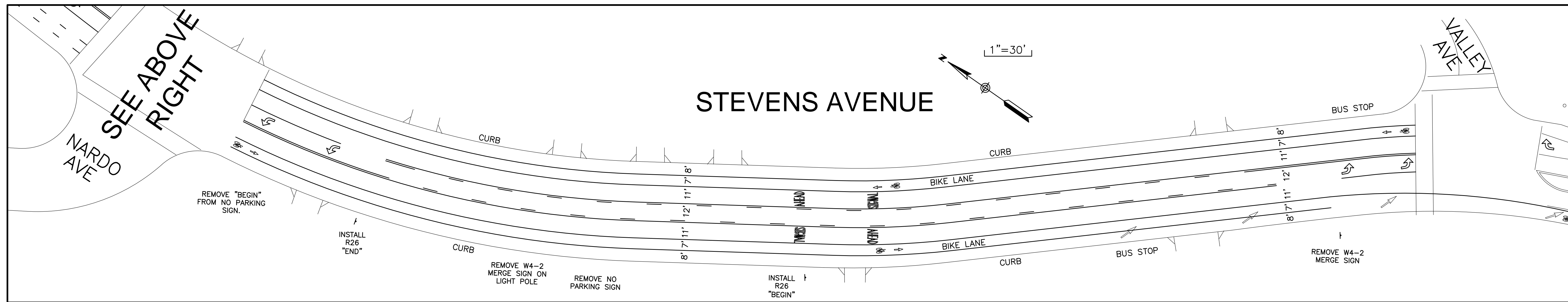

SEE BELOW LEFT

TRAFFIC STRIPING NOTES

1. THE CONTRACTOR SHALL STRIPE AND REPLACE ALL EXISTING STRIPING AND PAVEMENT MARKERS AS SHOWN ON THE PLANS.
2. NEW STRIPING SHALL BE APPLIED IN 2 COATS. EXISTING STRIPING TO REMAIN MAY BE PAINTED OVER WITH ONE COAT.
3. THE CONTRACTOR SHALL REMOVE BY MECHANICAL MEANS ALL CONFLICTING STRIPING, MARKERS AND PAVEMENT LEGENDS WITHIN THE AREA OF THE NEW STRIPING.
4. ALL DEBRIS TO BE REMOVED AT THE END OF EACH WORK DAY.
5. STRIPING AND PAVEMENT MARKINGS SHALL CONFORM TO SECTIONS 84 AND 85 OF THE CALTRANS STANDARD SPECIFICATIONS. ALIGNMENT AND LAYOUT IS SUBJECT TO CITY OF SOLANA BEACH ENGINEERING DEPARTMENT APPROVAL.
6. PAINT FOR TRAFFIC STRIPES SHALL BE RAPID DRY WATERBORNE, WHITE AND YELLOW 8010-42L-30 OR 8010-61G-10. GLASS BEADS SHALL CONFORM TO STANDARD SPECIFICATIONS NUMBER 8010-51J-22 (TYPE 1 - MOISTURE PROOF).
7. THINNING OF PAINT WILL NOT BE ALLOWED.
8. THERMOPLASTIC SHALL BE USED FOR CROSSWALKS.
9. INSTALL REFLECTIVE PAVEMENT MARKERS WHERE MISSING IN EXISTING PAVING.
10. ARROWS PER CALTRANS TYPE I (10'), TYPE IV & TYPE VII.

REMOVALS PRIOR TO SLURRY

PRIOR TO SLURRY SEAL, RAISED PAVEMENT MARKERS, LEGENDS (ARROWS, WORDS) AND ANY THERMOPLASTIC SHALL BE REMOVED.

TRAFFIC CONTROL NOTES

TRAFFIC CONTROL SHALL BE PROVIDED BY THE CONTRACTOR FOR HIS WORK. TRAFFIC CONTROL SHALL CONFORM TO THE CALTRANS TRAFFIC MANUAL, TRAFFIC CONTROLS FOR CONSTRUCTION AND MAINTENANCE, AND THE REGIONAL STANDARD DRAWINGS. THE CONTRACTOR SHALL SUBMIT A TRAFFIC CONTROL PLAN AND RECEIVE CITY APPROVAL FOR TRAFFIC CONTROL THAT DIFFERS FROM THOSE PLANS INCLUDED IN THE REGIONAL STANDARD DRAWINGS.

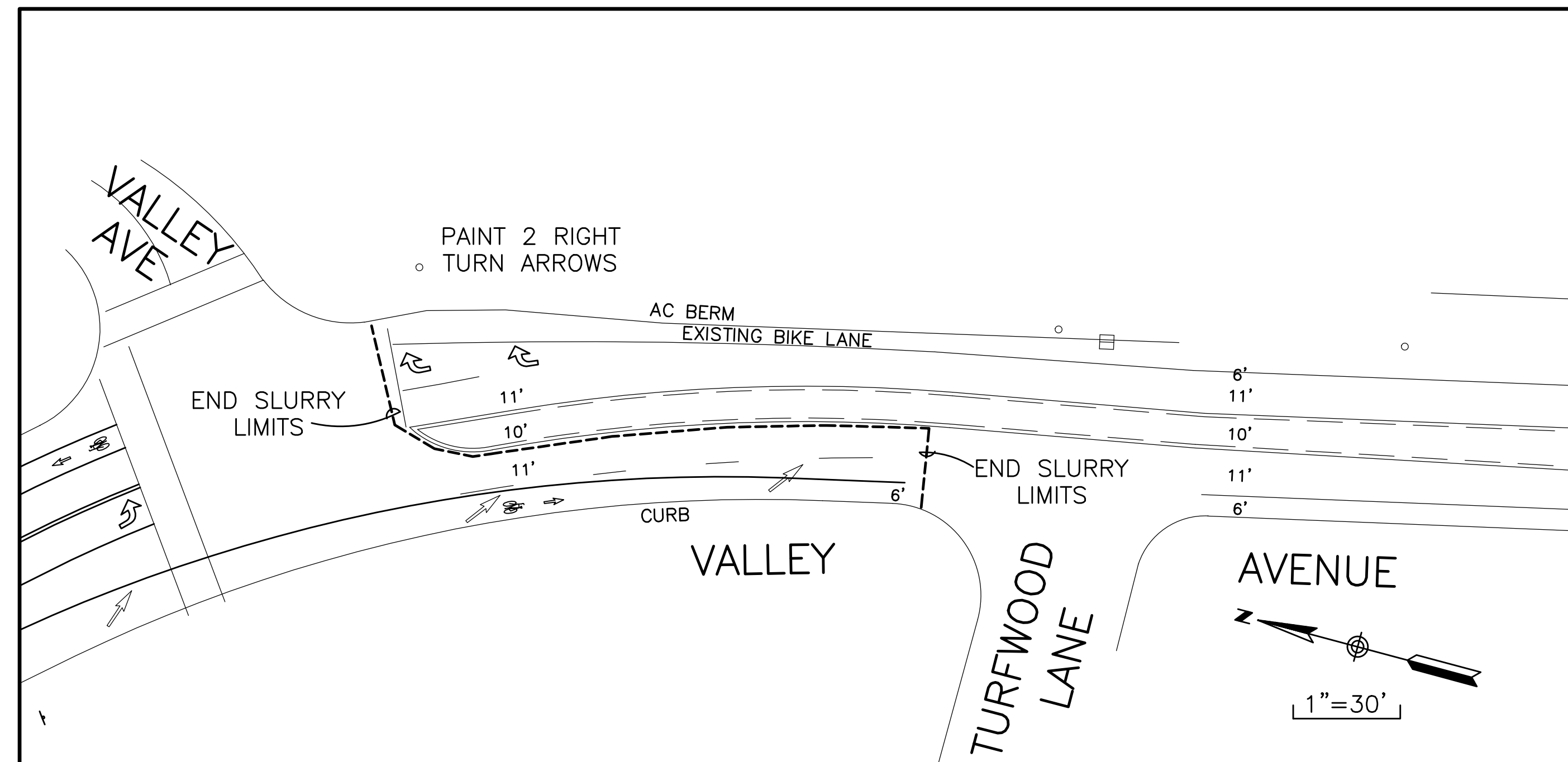

SEE ABOVE RIGHT

	ENGINEER OF WORK	CITY APPROVED CHANGES	APP'D DATE	RECOMMENDED FOR APPROVAL	CITY APPROVED CHANGES	APP'D DATE	APPROVED FOR CONSTRUCTION	CITY OF SOLANA BEACH	ENGINEERING DEPARTMENT	DRAWING NO.
	By: _____ Date: _____			By: _____ Date: _____			By: _____ Date: _____	SIGNING AND STRIPING PLANS FOR:		
Drawn By	JAMES D GREENSTEIN R.C.E.: 36502 Exp: 6/30/16						Mohammad Sammak, City Engineer R.C.E.: 37146 Exp: 6/30/16	STEVENS AVENUE		
								LA COLONIA PARK TO VALLEY AVENUE		Sheet 1 of 1